

Millermatic® 350P

Issued April 2013 • Index No. DC/12.51

MIG Arc Welding Power Source,
Wire Feeder and Gun Package



Quick Specs

Industrial Applications

Fabrication
Maintenance and Repair
Farm
Manufacturing
Industrial

Processes

MIG (GMAW)
Pulsed MIG (GMAW-P)
Flux-Cored (FCAW)

Rated Output 300 A at 32 VDC, 60% Duty Cycle, 60 Hz, 1- or 3-Phase Input Power

Amperage Range 25–400 A

Wire Feed Speed 50–700 IPM (1.3–18 m/min.) MIG Gun
50–800 IPM (1.3–20 m/min.) Spool Gun/Push-Pull Gun

Weight 181 lb. (82 kg)

The Power of Blue.®

Built-in Pulsed MIG programs

- .035 and .045 inch (0.9 and 1.2 mm) for mild or stainless steel.
- .035 and .047 inch (0.9 and 1.2 mm) for 4000 and 5000 series aluminum.
- .045 inch (1.2 mm) for metal core.

All programmed information is stored for MIG, push-pull and spool guns, and is restored after each power up.

Single- or three-phase input power with **line voltage compensation** for constant output even with fluctuations to the input power.

Aluminum Pulse Hot Start™

automatically provides more arc power to eliminate a “cold start” that is inherent with aluminum starts.

Superior aluminum performance .

Direct connection for optional XR™ push-pull guns or Spoolmatic® spool gun. With **Gun-On-Demand™**, simply pull the trigger for the gun to be used and you're ready to weld.

Fan-On-Demand™ cooling system only operates when needed, reducing power consumption and contaminants drawn into the machine.

Industrial, four-roll wire drive system features two easy-to-set, scaled, tension adjustments and quick-change reversible drive rolls for .035- and .045-inch (0.9 and 1.2 mm) wire.



Welds materials 22 gauge up to 1/2-inch (12.7 mm) thick.

Comes complete with:

- 15-ft. (4.6 m) Bernard® Q300 MIG gun with extra Centerfire™ contact tips
- 10-ft. (3 m) work cable with clamp
- 10-ft. (3 m) industrial power cord (without plug) for single- or three-phase
- Factory-installed gas solenoid
- Argon mix regulator/flow gauge and hose
- Factory-installed, low-mounted running gear/cylinder rack
- .035/.045-in. reversible V-groove drive rolls (order U-groove drive roll kits for aluminum welding)
- Set-up and operation CD

Special features

- Run-in adjustment for MIG, push-pull and spool guns.
- Built-in two-minute spot timer.
- Pre-flow and post-flow adjustment.
- View actual welding amperage/voltage during welding, and five seconds after arc has shutoff.
- SharpArc™ controls welding arc cone width in Pulsed MIG welding mode.
- Inductance control customizes weld output characteristics in MIG welding mode.

Internal timers

- **Adjustable crater** feature optimizes crater size for steel, stainless, aluminum and metal-core applications.
- **Crater time delay** allows deactivation of crater feature for tack or small welds.



Power source is warranted for 3 years, parts and labor.
Original main power rectified parts are warranted for 5 years.
Gun warranted for 90 days, parts and labor.



Miller Electric Mfg. Co.

An Illinois Tool Works Company
1635 West Spencer Street
Appleton, WI 54914 USA

Equipment Sales US and Canada

Phone: 866-931-9730
FAX: 800-637-2315
International Phone: 920-735-4554
International FAX: 920-735-4125

Website

MillerWelds.com



Specifications (Subject to change without notice.)



Rated Output	Amperage Range	Amps Input at Rated Output, 60 Hz					Wire Type and Diameter	Wire Feed Speed	Dimensions	Net Weight
		200 V	230 V	460 V	KVA	KW				
Three-Phase 300 A at 32 VDC, 60% Duty Cycle	25-400 A	34	30	15	11.6	11.5	Solid Steel .023-.045 in. (0.6-1.2 mm)	MIG Gun 50-700 IPM (1.3-18 m/min.)	H: 34 in. (863 mm)	181 lb. (82 kg)
Single-Phase 300 A at 32 VDC, 60% Duty Cycle		69	61	30	13.1	11.2	Aluminum .035-.047 in. (0.9-1.2 mm)	Spool Gun and Push-Pull Gun 50-800 IPM (1.3-20 m/min.)	W: 19 in. (483 mm)	
							Flux-Cored .030-.045 in. (0.8-1.2 mm)		D: 41 in. (1041 mm)	
							Metal-Cored .035-.052 in. (0.9-1.3 mm)			

Certified by Canadian Standards Association to both the Canadian and U.S. Standards.

Control Panel

1. Weld Mode Indicator Lights
2. Menu Set-Up Button
3. Adjustment Knobs
4. Weld Parameter Displays
5. Weld Function Indicator Lights
6. Arc Control Button

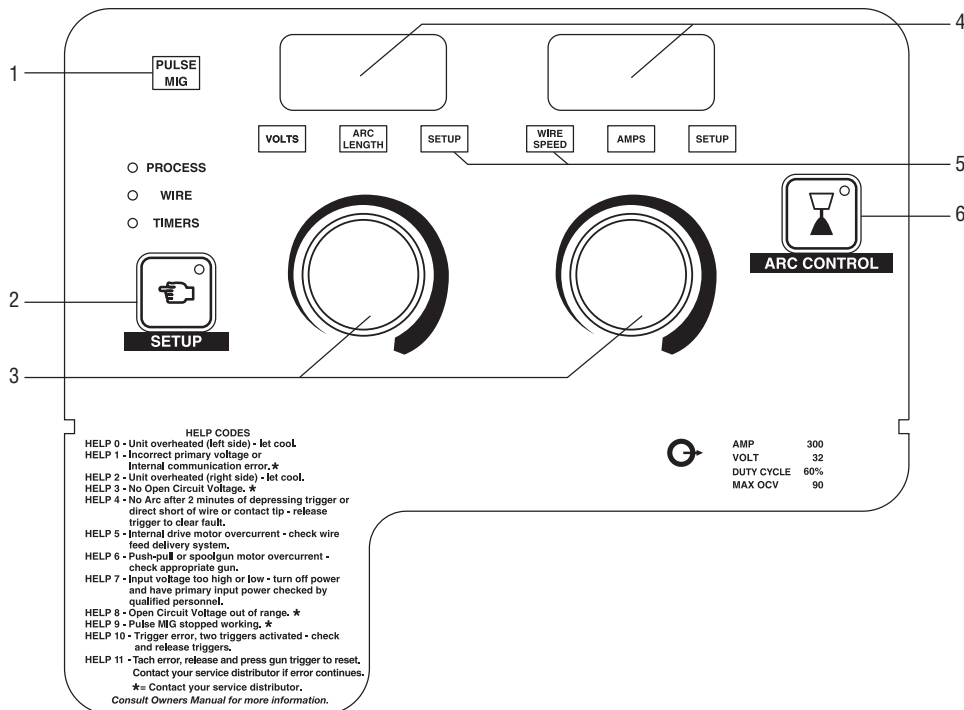

Performance Data

DUTY CYCLE CHART

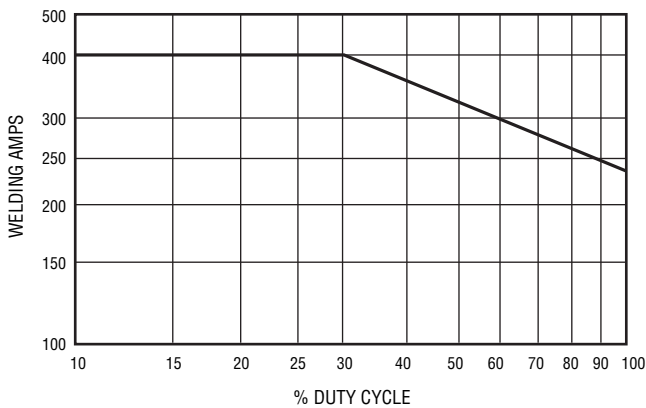

VOLT/AMP CURVES

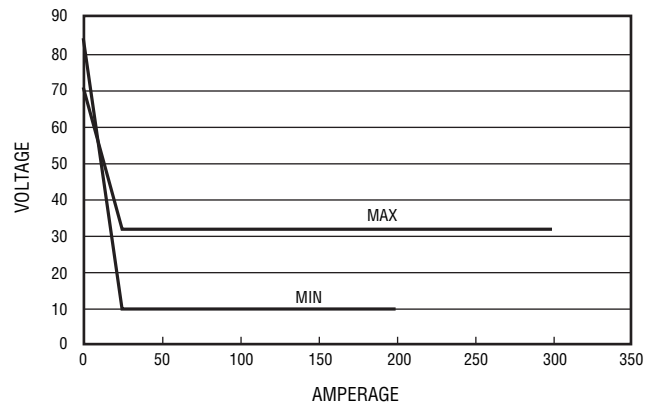

Guns

Bernard® Q300 MIG Gun #229 560

15-foot (4.6 m), 300-amp gun handles standard wire size .035–.045 inch (0.9–1.2 mm). Includes Centerfire™ contact tips.



Spoolmatic® 15A Spool Gun #195 156

Spoolmatic® 30A Spool Gun #130 831
Ideal for aluminum welding jobs. Air-cooled, 1-pound spool gun with 15-foot (4.6 m) or 30-foot (9.1 m) cable assembly. Rated at 200 amps at 100 percent duty cycle. For detailed information, see Spoolmatic literature, Index No. M/1.73.



XR-Aluma-Pro™ Lite Push-Pull Gun

#300 948 25 ft. (7.6 m)
Air-cooled gooseneck-style gun for .030–.047 in. (0.8–1.2 mm) aluminum. Rated at 175 amps at 60 percent duty cycle.



XR-Aluma-Pro™ Push-Pull Gun

#300 000 15 ft. (4.6 m)
#300 001 25 ft. (7.6 m)
#300 264 35 ft. (10.7 m)
Air-cooled gooseneck-style gun for .030–.047 in. (0.8–1.2 mm) aluminum. Rated at 200 amps at 100 percent duty cycle.



XR™ Pistol Push-Pull Gun

#198 127 15 ft. (4.6 m) cable
#198 128 30 ft. (9 m) cable
Air-cooled pistol grip gun for .030–.047 in. (0.8–1.2 mm) aluminum. Rated at 200 amps at 100 percent duty cycle.

U-Groove Aluminum Drive Roll and Accessory Kits for Push-Pull Guns

Note: XR-Aluma-Pro kits include Millermatic U-groove drive rolls, nylon wire guides and contact tips. XR-Pistol kits include Millermatic U-groove drive rolls, nylon wire guides, gun drive rolls and contact tips.

For XR-Aluma-Pro (air-cooled)

#195 311 .035 in. (0.9 mm)
#195 312 .040 in. (1 mm)
#195 313 .047 in. (1.2 mm)

For XR Pistol (air-cooled)

#195 201 .035 in. (0.9 mm)
#195 273 .040 in. (1 mm)
#195 202 .047 in. (1.2 mm)

Dual Cylinder Rack #195 299

Replaces single cylinder rack.

Millermatic® Protective Cover #195 142

CO₂ Regulator/Flow Gauge #212 492*

Required if using 100 percent CO₂ gas.

Power Cord Plug #213 380*

For 200- or 230-volt, single-phase application. Rated at 250 VAC/50 A NEMA-style 6-50P.

Consumables (Order from Miller Service Parts.)

For Bernard® Q300 MIG Gun

Centerfire™ Contact Tips (10 per package)

#T-023 .023 in. (0.6 mm)
#T-030 .030 in. (0.8 mm)
#T-035 .035 in. (0.9 mm)
#T-039 .039 in. (1.0 mm) steel and for .035 in. (0.9 mm) aluminum or stainless wires or metal core
#T-045 .045 in. (1.2 mm)
#T-052 .052 in. (1.3 mm) steel and for .047 in. (1.2 mm) aluminum or stainless wires or metal core

Nozzle #N-5800C

Screw-type copper, 5/8-inch (15.9 mm) orifice flush

Nozzle Insulator Cap #10012

Diffuser #D-1

Large Centerfire gas diffuser

Replacement Jump Liners

#QJL-2330
.023–.030 in. (0.6–0.8 mm)

#QJL-3545 Standard
.035–.045 in. (0.9–1.2 mm)

Replacement Liners

#43015
.023–.030 in. (0.6–0.8 mm)

#44115 Standard
.035–.045 in. (0.9–1.2 mm)

Millermatic® Drive Roll Kits

Note: Drive roll kits include four drive rolls, an intermediate guide, and an inlet guide.

V-Groove Drive Roll Kits

#087 132 .023/.025 in. (0.6 mm)
#046 780 .030 in. (0.8 mm)
#046 781 .035 in. (0.9 mm)
#046 782 .045 in. (1.2 mm)
#227 061 .035/.045 in. (0.9/1.2 mm)
#046 783 .052 in. (1.3 mm)
#046 784 1/16 in. (1.6 mm)

U-Groove Drive Roll Kits

#044 750 .035 in. (0.9 mm)
#046 785 .047 in. (1.2 mm)
#046 786 .052 in. (1.3 mm)
#046 787 1/16 in. (1.6 mm)

V-Knurled Drive Roll Kits

#046 792 .035 in. (0.9 mm)
#046 793 .045 in. (1.2 mm)
#046 794 .052 in. (1.3 mm)
#046 795 1/16 in. (1.6 mm)

Ordering Information

Equipment and Options	Stock No.	Description	Qty.	Price
Millermatic® 350P	#907 300	200/230/460 V, MIG/Pulsed MIG unit		
Guns				
Bernard® Q300 MIG Gun	#229 560	15 ft. (4.6 m), 300 A, .035–.045 in. (0.9–1.2 mm)		
Spoolmatic® 15A Spool Gun	#195 156	15 ft. (4.6 m), 200 A, .023–1/16 in. (0.6–1.6 mm) for aluminum		
Spoolmatic® 30A Spool Gun	#130 831	30 ft. (9 m), 200 A, .023–1/16 in. (0.6–1.6 mm) for aluminum		
XR-Aluma-Pro™ Lite Push-Pull Gun (air-cooled)	#300 948	25 ft. (7.6 m), 200 A, .030–1/16 in. (0.8–1.6 mm) for aluminum		
XR-Aluma-Pro™ Push-Pull Gun (air-cooled)	#300 000	15 ft. (4.6 m), 200 A, .030–1/16 in. (0.8–1.6 mm) for aluminum		
	#300 001	25 ft. (7.6 m), 200 A, .030–1/16 in. (0.8–1.6 mm) for aluminum		
	#300 264	35 ft. (10.7 m), 200 A, .030–1/16 in. (0.8–1.6 mm) for aluminum		
XR™-Pistol Push-Pull Gun (air-cooled)	#198 127	15 ft. (4.6 m), 200 A, .030–1/16 in. (0.8–1.6 mm) for aluminum		
	#198 128	30 ft. (9 m), 200 A, .030–1/16 in. (0.8–1.6 mm) for aluminum		
XR-Aluma-Pro™ U-Groove Aluminum Drive Roll Kits	#195 311	.035 (0.9 mm)		
	#195 312	.040 (1.0 mm)		
	#195 313	.047 (1.2 mm)		
XR™-Pistol U-Groove Aluminum Drive Roll Kits	#195 201	.035 (0.9 mm)		
	#195 273	.040 (1.0 mm)		
	#195 202	.047 (1.2 mm)		
Accessories				
Dual Cylinder Rack	#195 299	Field installed, replaces single cylinder rack		
Protective Cover	#195 142			
CO ₂ Regulator/Flow Gauge	#212 492	Required if using 100% CO ₂ gas (<i>Order from Miller Service Parts.</i>)		
Power Cord Plug	#213 380	For 200/230 V, single-phase. NEMA-style 6-50P (<i>Order from Miller Service Parts.</i>)		
Electrode Wire				
Shielding Gas Cylinder				
Helmet/Gloves/Scratch Brush				
Consumables (<i>Order from Miller Service Parts.</i>)				
Centerfire™ Consumables		See page 3		
Contact Tips				
Tapered Contact Tips				
Contact Tip Adapter				
Replacement Liners				
Nozzles				
Tapered Nozzles				
Drive Rolls				

Date:

Total Quoted Price:



Distributed by: